



Model Number:  
**F-WGCX-714019**

RF Components

# C-Band Waveguide Filter

3399 –3403 MHz

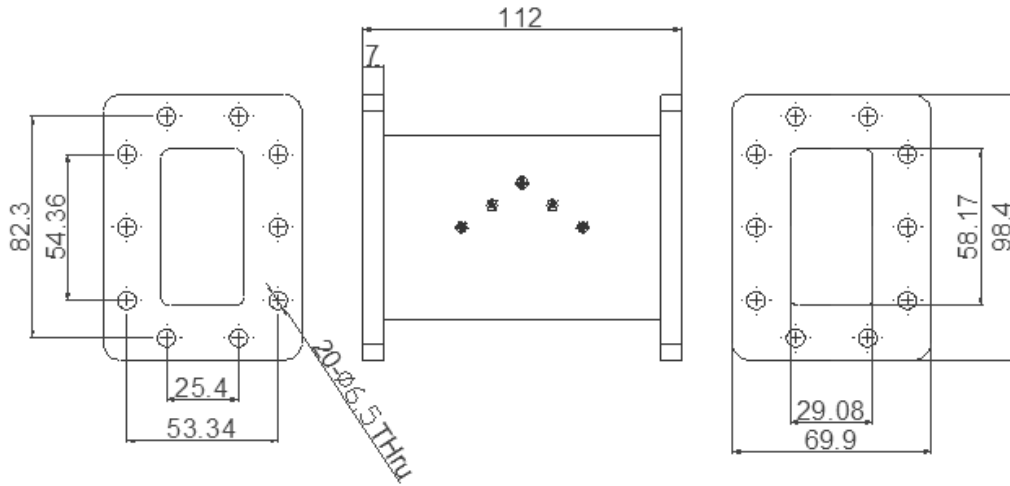

# Filter

RF Parameters	
<b>F-WGCX-714019</b>	
Waveguide Size	WG11A / WR229 / R40
Frequency Range (MHz)	3399-3403 MHz
Insertion Loss (dB) Max	1.5
Return Loss (dB) Min	17.6
Rejection	≥30 dB @ 3350 & 3420 MHz
Power	50W
Temperature	-10+60°C
Flanges	CPRF

## Broadcast



## Marine Oil & Gas



## SNG & VSAT



## Satellite Teleport

